

# GPAG Community Exhibition Space

## General Information

**GPAG Community Exhibition Space** is a program of the **Grimsby Public Art Gallery**, to display works by local Artists in the Main Lobby and on a designated wall in the Library. Most exhibitions are on display for approximately two months.

Artists interested in showing at in this space are required to be members in good standing of the Grimsby Public Art Gallery. Membership can be purchased in person at the Gallery or online via the Town of Grimsby activity registration portal:

<https://ca.apm.activecommunities.com/townofgrimsby/Membership>

Once an artist's work is scheduled for an exhibition, specific pieces to be displayed will be selected by the Exhibition Committee, in consultation with the Artist. It is necessary to have work prepared with some high quality jpeg images ahead of the exhibition dates, as it is necessary for media promotion, invitations and exhibition layout planning. The Gallery will arrange announcements of the exhibition in its newsletter, local newspapers, social media.

The Artist will be responsible for framing or otherwise preparing and transporting the work for presentation in the CES. The artist will be available to hang and present the work as well as for removal at the closing of the exhibition with the assistance of the Education Coordinator. Please refer to the hanging system requirements and consult us if you need further information. Any sculptural stands or cases required for the exhibition needs to be planned early as gallery stands are limited to availability and dependent on the needs of the main gallery exhibits.

The Gallery will take a 20% commission on sales. A formal opening may be arrange with the Education Coordinator at the Artist's expense, for a time and date that presents no conflict with previously scheduled Gallery and Library events.

### **Submissions:**

Applications are to be submitted on the form provided and should include: a résumé, an artist's statement and some visual samples of their work with full labels to each image as jpegs with 300 dpi resolution by email or on CD.

### **Submissions by mail should be addressed to:**

**Sandra Mercuri, Education Coordinator**  
**Grimsby Public Art Gallery**  
**18 Carnegie Lane**  
**Grimsby Ontario**  
**L3M 1Y1**  
**905-945-3246**

Or submit by email to: [gpag@grimsby.ca](mailto:gpag@grimsby.ca), attention: Sandra Mercuri



**COMMUNITY EXHIBITION SPACE  
ARTIST APPLICATION FORM:**

**Artists' Information:**

Name: \_\_\_\_\_

Address: \_\_\_\_\_

Phone Number: \_\_\_\_\_

E-Mail: \_\_\_\_\_

Social Media Links: (if applicable) \_\_\_\_\_

Website: (if applicable) \_\_\_\_\_

Description of work submitted:

\_\_\_\_\_  
\_\_\_\_\_  
\_\_\_\_\_  
\_\_\_\_\_  
\_\_\_\_\_

\_\_\_\_\_  
Artist Signature

**for Office use**

Accepted:  YES  NO

Exhibition Date from \_\_\_\_\_ To \_\_\_\_\_

\_\_\_\_\_  
The Gallery

\_\_\_\_\_  
Date

**GPAG Community Exhibition Space Floor Plan:**

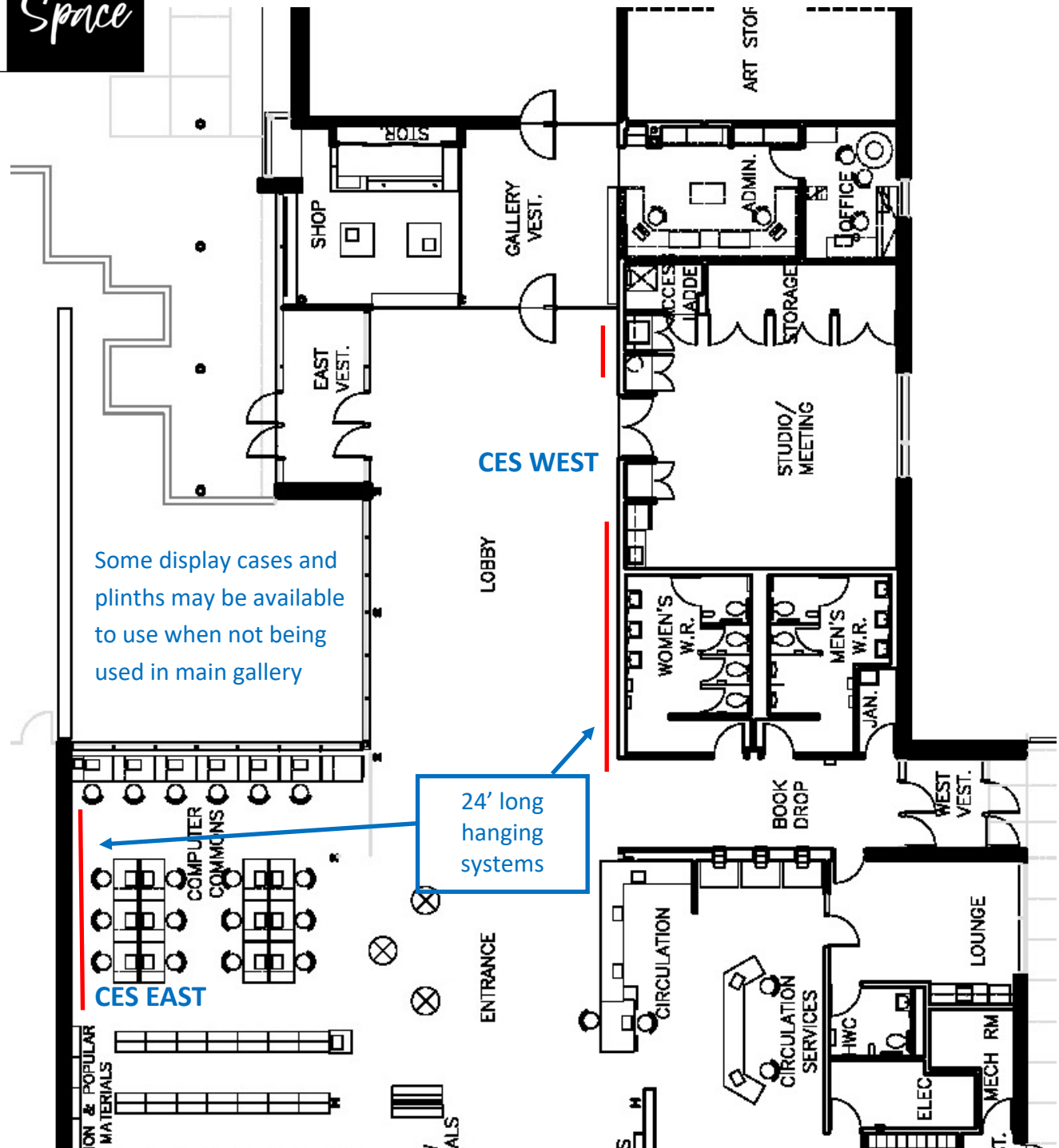

Some display cases and plinths may be available to use when not being used in main gallery

24' long hanging systems

**Hanging System:**

Currently the GPAG has enough hangers and hooks for up to 20 framed or wall-ready works or art, dependent on artwork sizing. Please note that any hanging art must have D clips attached, according to gallery standard, in order to hang flat. Some display cases and plinths may be available to use when not being used in main gallery.



## Hanging system for the CES

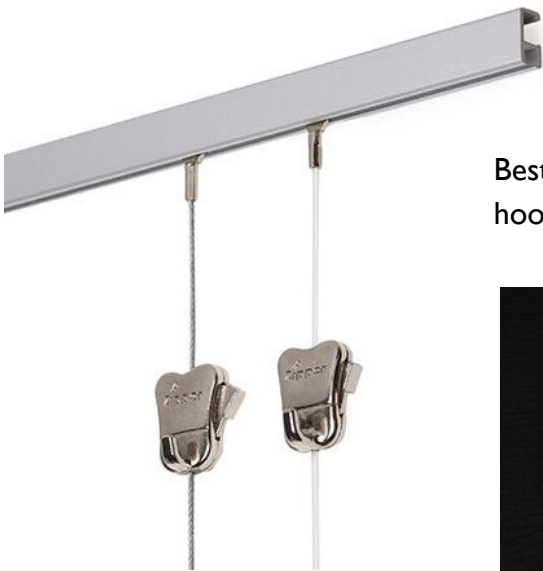

Best way to ensure we can keep the art balanced is to use D ring hook on each side on the back of the framed work.



The gallery has a wall mounted artist statement location and plinth for comment books. Artists are welcome to bring their own guest book if preferred.

If you have any questions about hardware location or other exhibition details, please contact  
905-945-3246  
[gpag@grismby.ca](mailto:gpag@grismby.ca)

# GPAG COMMUNITY EXHIBITION SPACE

## Program Details

### **Exhibition Duration**

Community artists will be booked for exhibitions that run for one to two months in the East and/or West Exhibition spaces, from July to December. Our Education Series will run one for month at a time, from January to May.

### **Selection**

A Call for Artists is open year round with selection of submissions completed each December for the next calendar year from June-December.

### **Display**

Size and number of works will be limited by the space available.

### **Commission**

A 20% commission will be applied to all sales. Details included in exhibition agreement form, once your submission has been selected.

### **Eligibility**

Artists working in any fine art or craft media are eligible to apply and must be from the Niagara Region.

### **Publicity**

Will include requests for newspaper coverage, an announcement in the Gallery Newsletter, e-mails, social media posts and a printed exhibition invitation.

More details to be outlined on the exhibition agreement form.